



★★★  
**2 MINUTES**  
FROM  
NATIONAL PUBLIC  
SCHOOL,  
BANASHANKARI

VISIT NEW MODEL FLAT

# THERE IS SOMETHING MAGICAL FOR EVERYONE!



**BRIGADE**  
**7 GARDENS**  
BANASHANKARI

Brigade7Gardens.org









# THE GARDENS WELCOME YOU

**Brigade 7 Gardens is nature's address in South Bangalore. Experience a truly unique landscape where luxurious towers are surrounded by seven beautiful gardens. Sit back and watch life blossom in the midst of nature and luxury.**





GARDENS

BRIGADE  
7 GARDENS CLUB HOUSE

GARDENS

BRIGADE



# 7 GARDENS OF HAPPINESS

A garden is a place where we can sit back and take in the little pleasures of life. We may visit a garden to find kinship, or sometimes, a little solitude. We can play like children or just bask in the sunshine. We may wish to enjoy nature's bounty or perhaps even little magic. How wonderful would it be if we had a special garden for each of our pleasures?

All of our seven gardens have been conceptualised with the idea of beautifying every aspect of life, and have been landscaped not on podiums but on rich, fertile soil, just the way nature intended.





## The 7 Magical Gardens



### The Garden of Solitude

Spending some quality time by ourselves has become imperative in a world where we are always connected. With quiet corners, calming water features, and beautiful stone groupings, the Garden of Solitude is an oasis of serenity and rejuvenation.



### The Garden of Surprise

Nothing is quite as magical as nature. The Garden of Surprise has been crafted to bring out the most wondrous, amazing aspects of nature. Step into a colourful wonderland packed with scaled up as well as minituarised landscaping and awe-inspiring sculptures that add a touch of fantasy to the ambience.

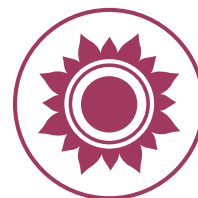

### The Garden of Sway

Created to bring out the inner child in all of us, the Garden of Sway is full of fun activities and exercise areas. Equipped with play courts, jogging tracks, and open gardens, it is the perfect place for the young and the young at heart.

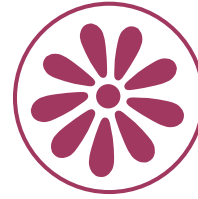

## The Garden of Sunshine

The solar garden is the place to experience a brilliant sunshine at the terraces of BGS. With city views and interactive spaces, it is designed to be the right place where the breeze and the sunshine takes over one's experience. Planting in these landscape terraces adds more softness to the visual experience. It should also be a place to learn and enjoy tapping the world's best source of energy.



## The Garden of Senses

A wondrous garden that has been created to evoke our sense of sight, smell, sound, touch and above all else, wonder. Whether it's the fragrance of aromatic flowers, the sounds of birds chirping, or even the motion sensor fountains, the garden of senses is a delightful place to spend the afternoon.



## The Garden of Source

Who doesn't love fresh produce from their own backyard? With mango, banana, gooseberry and lemon trees, along with vegetable patches, the Garden of Source is a dream come true for organic food lovers.



## The Social Garden

This sprawling garden is specially designed so that we can make the most of our time with friends and family. Apart from the beautiful park benches and walking paths, the Social Garden also boast for its event space and a clubhouse. So, let's find every excuse to spend time with those we love.

# LIVE IN A FAST-GROWING NEIGHBOURHOOD

# KEY DISTANCES



## Major Junctions & Landmarks

Dr. Vishnuvardhan Road  
Uttarahalli Main Road  
NICE Road  
KSIT Metro Station  
Yelachanahalli Metro Station  
Banashankari Temple



## Workplaces

Global Village Tech Park  
Oracle  
Toyota  
Bosch  
VM Ware Accenture



## EDUCATION, HEALTHCARE & RECREATION IS JUST A FEW MINUTES AWAY



### Schools

National Public School  
Delhi Public School  
Sri Kumaran Children's Home  
Jnana Sweekar Public School



### Colleges

KSIT Engineering College  
Dayanand Sagar International  
School & College



### Healthcare

BGS Hospital  
Ritu Hospital  
SS Hospital



### Shopping & Entertainment

Metro Cash & Carry  
Gopalan Arcade Mall

## REJUVENATION IS JUST A SHORT DRIVE AWAY



### Turahalli Reserved Forest

A 600 acre green reserve ensuring  
nature's bounty and tranquility



### Art of Living International Center

Bangalore's favourite spirituality  
and self-improvement centre.



### Paduka Mandira

Sri Sadguru Chaitanya is a very popular  
temple of Sri Venkatachala Avadhoota  
who got much of his inspiration to life  
from the 33rd Jagadguru of Sringeri Mutt,  
Sri Chandrashekhara Bharati Mahaswami.



### ISKCON Theme Park

A magnificent cultural complex devoted  
of Lord Krishna.



Brigade 7 Gardens is nature's address in South Bangalore







# CO-DESIGNED BY NATURE

Seven stately towers, rising above the lush foliage and rolling hillocks of Banashankari. The inspired architecture blends seamlessly with the natural beauty of landscape, inviting you to this haven of tranquility. No matter where you look, you will always have a view of one of the seven gardens that surround your home. Intricate trellises woven with exotic vines have been incorporated in the architecture of each home, ensuring plenty of greenery on every floor. And, the Thurahalli forest keeps every home blessed with bounty of fresh air.





## ENJOY THE SIMPLE JOYS OF LIFE

From farming your home produce to working out in an open-air gymnasium, living in Brigade 7 Gardens is all about relishing the simple joys of life, in luxury.



Multi-purpose hall



Swimming pool



Billiards



Convenience store



Table tennis



Badminton court



Aerobics



Gymnasium



Swimming Pool





Towers surrounded by 7 beautiful gardens





Enjoy fresh produce from the Garden of Source





Watch the kids play at the Garden of Sway





## The delightful Garden of Senses





Rejuvenate at the Garden of Solitude









# MASTER PLAN OF BRIGADE 7 GARDENS – ALL BLOCKS



## LEGEND

- |                          |                               |
|--------------------------|-------------------------------|
| 1. ENTRY & EXIT          | 13. THE GARDEN OF SURPRISE    |
| 2. CLUB ENTRY            | 14. THE GARDEN OF SENSES      |
| 3. BLOCK ENTRY           | 15. THE GARDEN OF SWAY        |
| 4. DRIVEWAY              | 16. THE GARDEN OF SOLITUDE    |
| 5. BRIDGE                | 17. SUNKEN SEATING            |
| 6. PARKING               | 18. NALA BUFFER AREA PLANTING |
| 7. BASEMENT RAMP         | 19. THE SOCIAL GARDEN         |
| 8. BASKETBALL COURT      | 20. TRANSFORMER YARD          |
| 9. TENNIS COURT          | 21. OWC                       |
| 10. BADMINTON COURT      | 22. GAS BANK                  |
| 11. THE GARDEN OF SOURCE | 23. RMU                       |
| 12. SEATING AREA         |                               |





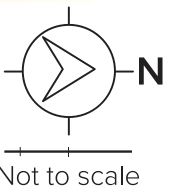



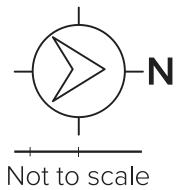
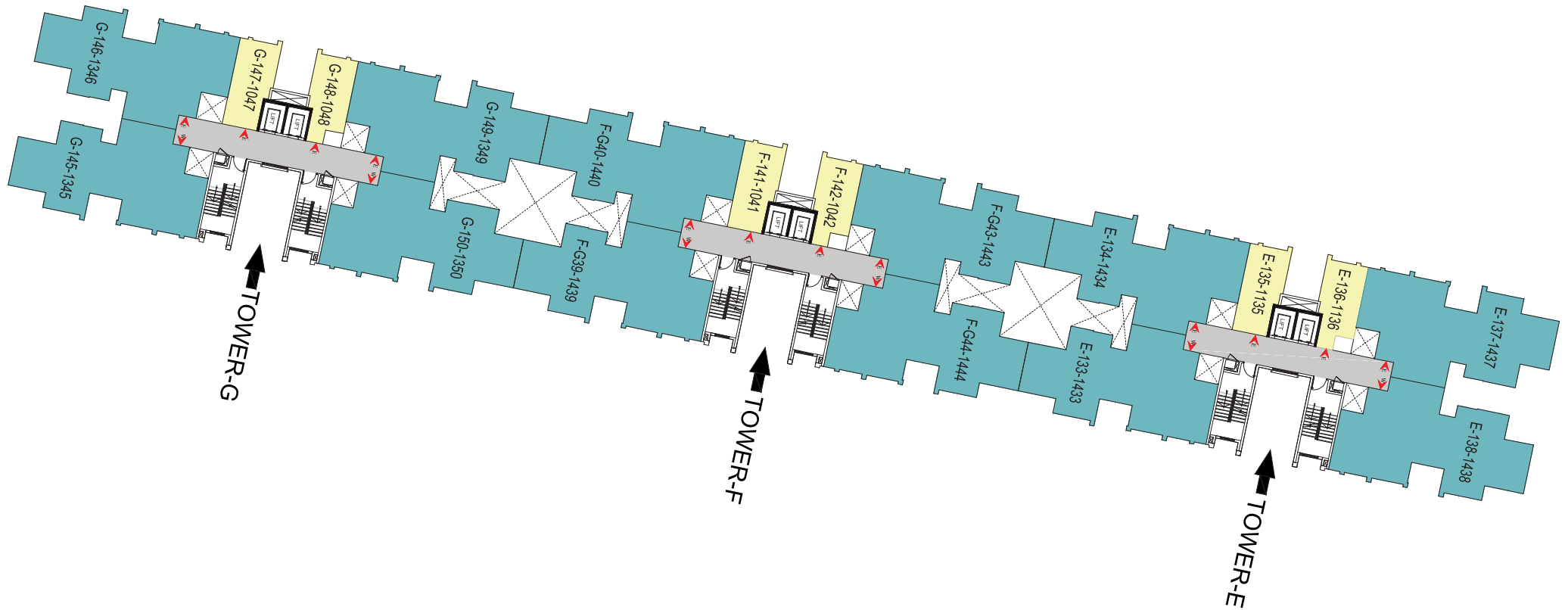

600 ACRE  
THURAHALLI FOREST RESERVE





# NUMBERING PLAN OF BRIGADE 7 GARDENS – ALL BLOCKS



UNIT TYPE		
	TYPE-01	2 BEDROOMS + 2 TOILETS
	TYPE-02	3 BEDROOMS + 2 TOILETS
	TYPE-03	3 BEDROOMS + 2 TOILETS
	TYPE-04	2 BEDROOMS + 2 TOILETS
	TYPE-05	3 BEDROOMS + 2 TOILETS
	TYPE-06	2 BEDROOMS + 2 TOILETS
	TYPE-07	3 BEDROOMS + 3 TOILETS
	STUDIO	1 BEDROOM + 1 TOILET





# NUMBERING PLAN OF TOWERS B, C & D (G+14 Floors)

**TOWER B**

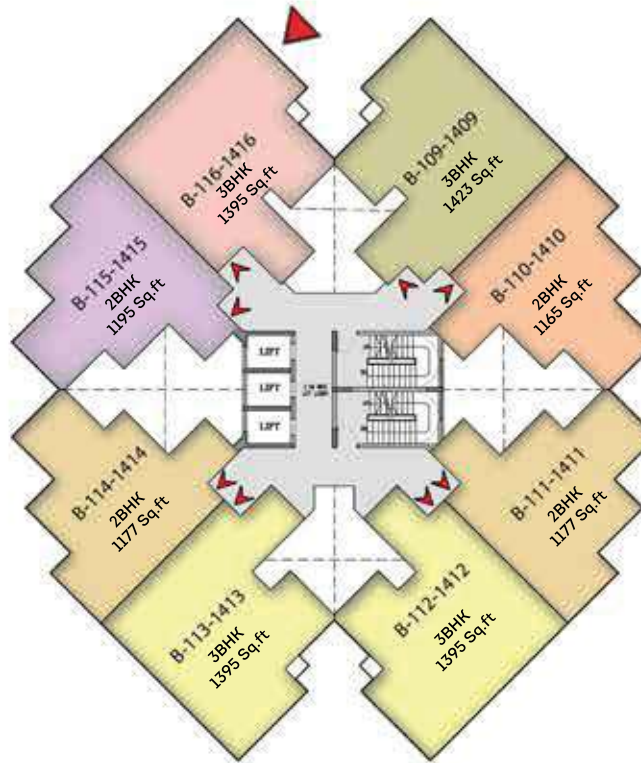

**TOWER C**

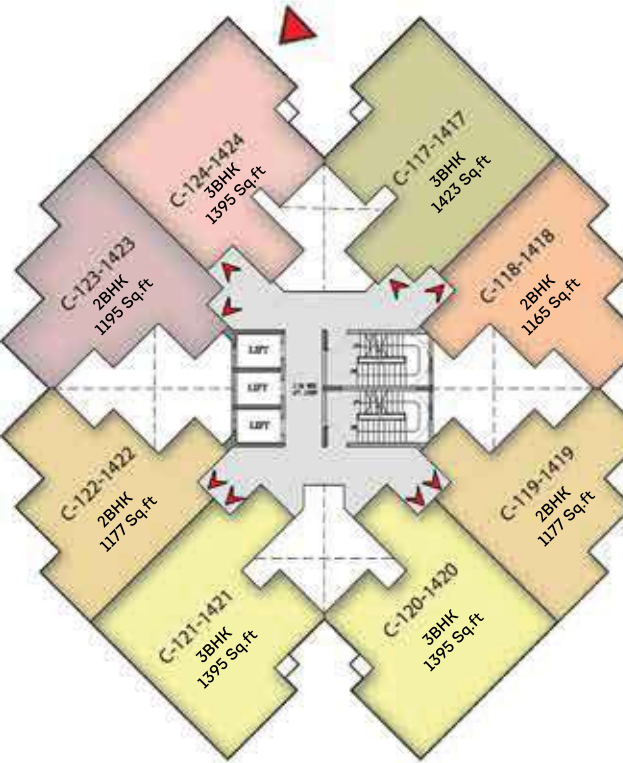

**TOWER D**

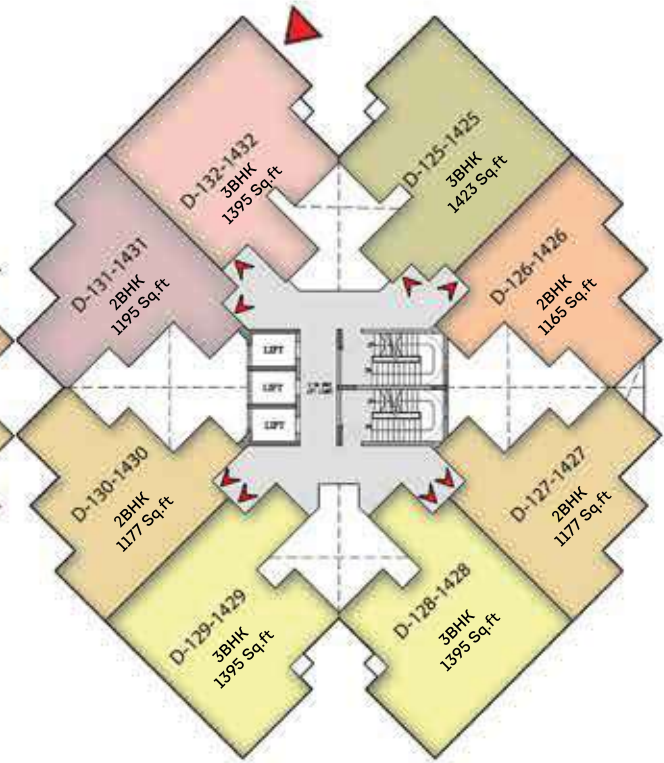

2BHK: 1165 Sq.ft (10, 18, 26)	3BHK: 1395 Sq.ft (13, 16, 21, 23, 29, 31)
2BHK: 1177 Sq.ft (14, 22, 30, 11, 19, 27)	3BHK: 1423 Sq.ft (09, 12, 17, 20, 25, 28)
2BHK: 1195 Sq.ft (15, 23, 31)	

LEGEND:	
	TYPE-01
	TYPE-02
	TYPE-03
	TYPE-04
	TYPE-05
	TYPE-06





# NUMBERING PLAN OF TOWERS E & F (G + 14 Floors) and G (G + 13 Floors)

## TOWER E (G+14 Floors)

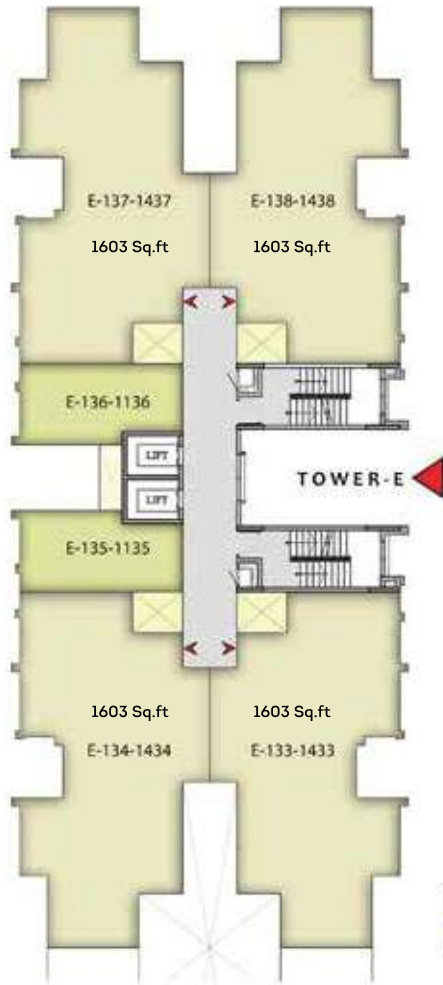

## TOWER F (G+14 Floors)

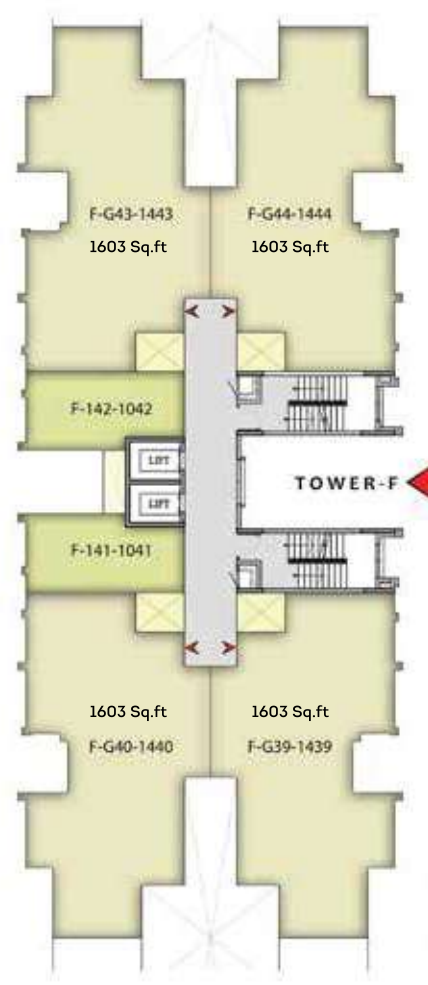

## TOWER G (G+13 Floors)

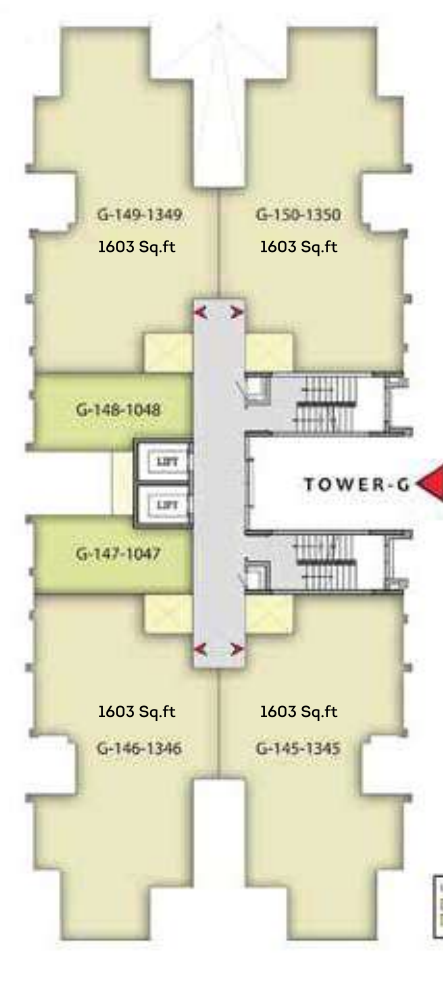

E Block: 1603 Sq.ft (37, 38, 33, 34)	Studio Apt: 371 Sq.ft (35, 36)
F Block: 1603 Sq.ft (39, 40, 43, 44)	Studio Apt: 371 Sq.ft (41, 42)
G Block: 1603 Sq.ft (45, 46, 49, 50)	Studio Apt: 371 Sq.ft (47, 48)



# TYPICAL STUDIO UNIT

## SUPER BUILT-UP AREA

371 sq.ft. / 34.46 sq.m.  
(Shown below)

## CARPET AREA

244.45 sq.ft. / 22.70 sq.m.  
(Shown below)

## SERIES

E Block: 35 & 36 | G Block: 47 & 48  
F Block: 41 & 42



## BLOCK PLAN

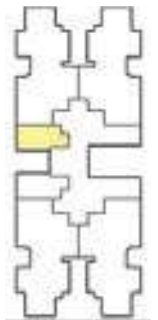

E, F, G

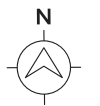

Not to scale

The information depicted herein viz., master plans, floor plans, furniture layout, fittings, illustrations, specifications, designs, dimensions, rendered views, colours, amenities and facilities etc., are subject to change without notifications as may be required by the relevant authorities or the developer's architect, and cannot form part of an offer or contract. Whilst every care is taken in providing this information, the Developer cannot be held liable for variations. All illustrations and pictures are artist's impression only. The information are subject to variations, additions, deletions, substitutions and modifications as may be recommended by the company's architect and/or the relevant approving authorities. The Developer is wholly exempt from any liability on account of any claim in this regard. (1 square metre = 10.764 square feet). E & OE.

Carpet area is defined as the net usable floor area of an apartment, excluding the area covered by the external walls, areas under services shafts, exclusive balcony or verandah area and exclusive open terrace area, but includes the area covered by the internal partition walls of the apartment.



# TYPICAL UNIT PLAN

## 2-Bedroom 2-Toilet Unit

### SUPER BUILT-UP AREA

1165 sq.ft. / 108.22sq.m.  
(Shown below)

### CARPET AREA

758.97 sq.ft. / 70.51 sq.m.  
(Shown below)

### SERIES

A Block: 1 & 8  
B Block: 10

C Block: 18  
D Block: 26



BLOCK PLAN

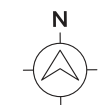
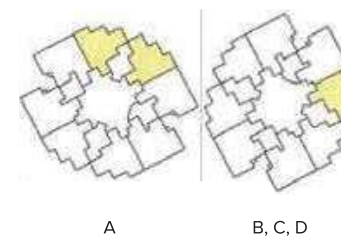

Not to scale

The information depicted herein viz., master plans, floor plans, furniture layout, fittings, illustrations, specifications, designs, dimensions, rendered views, colours, amenities and facilities etc., are subject to change without notifications as may be required by the relevant authorities or the developer's architect, and cannot form part of an offer or contract. Whilst every care is taken in providing this information, the Developer cannot be held liable for variations. All illustrations and pictures are artist's impression only. The information are subject to variations, additions, deletions, substitutions and modifications as may be recommended by the company's architect and/or the relevant approving authorities. The Developer is wholly exempt from any liability on account of any claim in this regard. (1 square metre = 10.764 square feet). E & OE.

Carpet area is defined as the net usable floor area of an apartment, excluding the area covered by the external walls, areas under services shafts, exclusive balcony or verandah area and exclusive open terrace area, but includes the area covered by the internal partition walls of the apartment.



# TYPICAL UNIT PLAN

## 2-Bedroom 2-Toilet Unit

### SUPER BUILT-UP AREA

1177 sq.ft. / 109.35 sq.m.  
(Shown below)

### CARPET AREA

764.14 sq.ft. / 70.9 sq.m.  
(Shown below)

### SERIES

A Block: 4 & 5 | C Block: 19 & 22  
B Block: 11 & 14 | D Block: 27 & 30



BLOCK PLAN

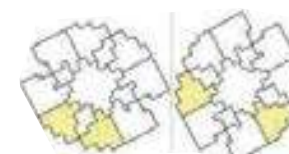

A

B, C, D



Not to scale

The information depicted herein viz., master plans, floor plans, furniture layout, fittings, illustrations, specifications, designs, dimensions, rendered views, colours, amenities and facilities etc., are subject to change without notifications as may be required by the relevant authorities or the developer's architect, and cannot form part of an offer or contract. Whilst every care is taken in providing this information, the Developer cannot be held liable for variations. All illustrations and pictures are artist's impression only. The information are subject to variations, additions, deletions, substitutions and modifications as may be recommended by the company's architect and/or the relevant approving authorities. The Developer is wholly exempt from any liability on account of any claim in this regard. (1 square metre = 10.764 square feet). E & OE.

Carpet area is defined as the net usable floor area of an apartment, excluding the area covered by the external walls, areas under services shafts, exclusive balcony or verandah area and exclusive open terrace area, but includes the area covered by the internal partition walls of the apartment.



# TYPICAL UNIT PLAN

## 2-Bedroom 2-Toilet Unit

### SUPER BUILT-UP AREA

1195 sq.ft. / 111.05 sq.m.  
(Shown below)

### CARPET AREA

775.33 sq.ft. / 72.03 sq.m.  
(Shown below)

### SERIES

B Block: 15  
C Block: 23

D Block: 31



BLOCK PLAN



B, C, D

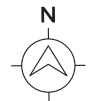

Not to scale

The information depicted herein viz., master plans, floor plans, furniture layout, fittings, illustrations, specifications, designs, dimensions, rendered views, colours, amenities and facilities etc., are subject to change without notifications as may be required by the relevant authorities or the developer's architect, and cannot form part of an offer or contract. Whilst every care is taken in providing this information, the Developer cannot be held liable for variations. All illustrations and pictures are artist's impression only. The information are subject to variations, additions, deletions, substitutions and modifications as may be recommended by the company's architect and/or the relevant approving authorities. The Developer is wholly exempt from any liability on account of any claim in this regard. (1 square metre = 10.764 square feet). E & OE.

Carpet area is defined as the net usable floor area of an apartment, excluding the area covered by the external walls, areas under services shafts, exclusive balcony or verandah area and exclusive open terrace area, but includes the area covered by the internal partition walls of the apartment.



# TYPICAL UNIT PLAN

## 3-Bedroom 2-Toilet Unit

### SUPER BUILT-UP AREA

1395 sq.ft. / 129.59 sq.m.  
(Shown below)

### CARPET AREA

922 sq.ft. / 85.63 sq.m.  
(Shown below)

### SERIES

A Block: 3 & 6  
B Block: 12, 13 & 16  
C Block: 20, 21  
D Block: 28, 29



BLOCK PLAN

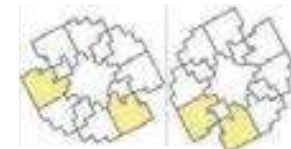

A

B, C, D

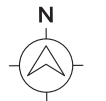

Not to scale

The information depicted herein viz., master plans, floor plans, furniture layout, fittings, illustrations, specifications, designs, dimensions, rendered views, colours, amenities and facilities etc., are subject to change without notifications as may be required by the relevant authorities or the developer's architect, and cannot form part of an offer or contract. Whilst every care is taken in providing this information, the Developer cannot be held liable for variations. All illustrations and pictures are artist's impression only. The information are subject to variations, additions, deletions, substitutions and modifications as may be recommended by the company's architect and/or the relevant approving authorities. The Developer is wholly exempt from any liability on account of any claim in this regard. (1 square metre = 10.764 square feet). E & OE.

Carpet area is defined as the net usable floor area of an apartment, excluding the area covered by the external walls, areas under services shafts, exclusive balcony or verandah area and exclusive open terrace area, but includes the area covered by the internal partition walls of the apartment.



# TYPICAL UNIT PLAN

## 3-Bedroom 2-Toilet Unit

### SUPER BUILT-UP AREA

1423 sq.ft. / 132.23 sq.m.  
(Shown below)

### CARPET AREA

942 sq.ft. / 87.56 sq.m.  
(Shown below)

### SERIES

A Block: 7  
B Block: 9

C Block: 17  
D Block: 25



BLOCK PLAN

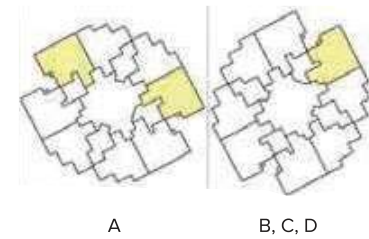

The information depicted herein viz., master plans, floor plans, furniture layout, fittings, illustrations, specifications, designs, dimensions, rendered views, colours, amenities and facilities etc., are subject to change without notifications as may be required by the relevant authorities or the developer's architect, and cannot form part of an offer or contract. Whilst every care is taken in providing this information, the Developer cannot be held liable for variations. All illustrations and pictures are artist's impression only. The information are subject to variations, additions, deletions, substitutions and modifications as may be recommended by the company's architect and/or the relevant approving authorities. The Developer is wholly exempt from any liability on account of any claim in this regard. (1 square metre = 10.764 square feet). E & OE.

Carpet area is defined as the net usable floor area of an apartment, excluding the area covered by the external walls, areas under services shafts, exclusive balcony or verandah area and exclusive open terrace area, but includes the area covered by the internal partition walls of the apartment.

# TYPICAL UNIT PLAN

## 3-Bedroom 3-Toilet Unit

### SUPER BUILT-UP AREA

1603 sq.ft. / 148.94 sq.m.  
(Shown below)

### CARPET AREA

1059.29 sq.ft. / 98.41 sq.m.  
(Shown below)

### SERIES

E Block: 33, 34, 37 & 38  
F Block: 39, 40, 43 & 44  
G Block: 45, 46, 49 & 50



BLOCK PLAN

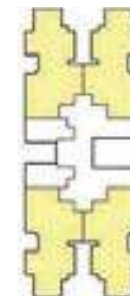

E, F, G



Not to scale

The information depicted herein viz., master plans, floor plans, furniture layout, fittings, illustrations, specifications, designs, dimensions, rendered views, colours, amenities and facilities etc., are subject to change without notifications as may be required by the relevant authorities or the developer's architect, and cannot form part of an offer or contract. Whilst every care is taken in providing this information, the Developer cannot be held liable for variations. All illustrations and pictures are artist's impression only. The information are subject to variations, additions, deletions, substitutions and modifications as may be recommended by the company's architect and/or the relevant approving authorities. The Developer is wholly exempt from any liability on account of any claim in this regard. (1 square metre = 10.764 square feet). E & OE.

Carpet area is defined as the net usable floor area of an apartment, excluding the area covered by the external walls, areas under services shafts, exclusive balcony or verandah area and exclusive open terrace area, but includes the area covered by the internal partition walls of the apartment.



# SPECIFICATIONS

## FOUNDATION

Isolated/Combined footing

---

## SUPER STRUCTURE

RCC framed structure

---

## BLOCK WORK

Block work

---

## FLOORING-COMMON AREAS

Waiting lounge/reception/GF Lobby/

Lift lobby: Granite/Vitrified tiles

Staircases: Step tiles/Stone-Eurocon

Other lift Lobby and corridor (Upper): Vitrified tiles - 600 x 600mm

Service lift lobby: Vitrified tiles - 600 x 600 mm

MEP rooms: IPS floor with smooth finish

Terrace: Clay tiles with water proofing

Basement: VDF/IPS with smooth finish

## FLOORING-RECREATION HOUSE (CLUB)

Lobby: Vitrified flooring

Gym: Vinyl flooring

Multipurpose hall: Vitrified flooring

---

## FLOORING-UNITS

Living/Dining/Family/Foyer: Vitrified tiles-600 x 600 mm

Master Bedrooms: Laminated wood en flooring /Vitrified flooring

Balcony/Deck: Antiskid ceramic tiles - 300 x 300 mm

Master Bedroom toilet: Ceramic tiles

Other toilets and powder room: Ceramic tiles

Kitchen: Vitrified tiles - 600 x 600 mm

Utility: Vitrified tiles - 600 x 600 mm (same as kitchen tiles)

Studio unit: Vitrified tiles - 600 x 600 mm (same as kitchen tiles)

---

## WALL DADO

Master Bedroom toilet: Glazed tile cladding upto false ceiling

Other toilets: Glazed tile cladding upto false ceiling.

# SPECIFICATIONS

## KITCHEN

**Counter:** Provision for modular kitchen

**Plumbing/Electrical:** Plumbing: Provision for water purifier/hot & cold water mixer in sink and washing machine

**Electrical:** 16 amps-3 numbers (washing machine, microwave oven, instant geyser), 6 amps-5 numbers (fridge/hob/chimney/aquaguard/mixer/exhaust)

---

## TOILETS

**CP Fittings:** AU CP fittings of ESS ESS/Jaguar or equivalent

**Sanitary fixtures:** Wall mounted white EWC with exposed flush tank (Parryware/Hindware/equivalent) with low level ceramic flushing tank of standard make including health faucet

**Accessories:** Soap tray, toilet paper holder, basin mixer, robe hook, towel rod, health faucet

**Master bedroom toilet:** Shower partition at extra cost as per client request

**Shower:** Wall Mixer for shower (Jaquar/Ess Ess or equivalent)

Wash basin-counter top: Master Bathroom - Granite counter other bathrooms - readymade counter and wash basin

**False Ceiling:** Sintex/calcium silicate 2'X2' Grid

## DOORS

**Main entry door - to unit:** Hardwood door frames with designer panel shutters polished on both sides. Night latch for main door with Magic eye

**Bedroom doors:** Flush door with both side Synthetic Enamel painted. Mortice lock for bedrooms only

**Toilet door:** Hard wood frame both side commercial flush shutter resin coated and thumb turn for the toilets

**Utility:** Not provided as utility is part of kitchen. Only window provided

**Balcony door:** UPVC/Aluminium glazed sliding door

**Shaft door:** MS door frame with steel shutter/standard

---

## RAILING

**Balcony railing:** MS railing-vertical only and spacing to be not more than 150 mm

**Staircase Railing (Common areas):** MS railing-vertical only and spacing to be not more than 150 mm





## WAKE UP TO A GARDEN BREEZE EVERY MORNING.

Wake up to the view of a unique garden that lends to the essence of living in the Garden City. Comprising of 2 & 3 bedroom apartments, designed to maximise ventilation, the airy interiors allow you to enjoy the cool breeze of the gardens, even when you're indoors.





Our Core Values

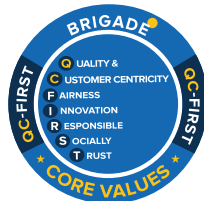

Founders



Awarded  
11 years in a row



---

**To UPGRADE TO BRIGADE, call us at 1800 102 9977 | email: [salesenquiry@brigadegroup.com](mailto:salesenquiry@brigadegroup.com)**

---

**Marketing Office:** Brigade 7 Gardens, Patalamma Temple Road, Near Bharath Housing Society, Dr. Vishnuvardhan Road, Uttarahalli, Bengaluru, Karnataka-560061,

**Also, visit us at**

**Experience Centre:** Ground Level, World Trade Center, Brigade Gateway Campus, Dr. Rajkumar Road, Malleswaram-Rajajinagar, Bangalore.

**Dubai Office:** Brigade Enterprises Limited, 708, Atrium Centre, Bank Street, Bur Dubai, Dubai. Tel: +971 4 3555504 email: [dubaisales@brigadegroup.com](mailto:dubaisales@brigadegroup.com)

Offices also in Chennai, Hyderabad, Mangalore and Mysore

---

RERA Registration No. PRM/KA/RERA/1251/310/PR/171021/000508